

## CVS Controls Ltd.

### Series HPV 30

### High Pressure Ball Valve

The CVS Controls Series HPV 30 is a 2 inch 3000psi High Pressure Ball Valve.

#### Features:

- Investment cast body construction
- 2 Piece Body Design
- Full Port – 2" design
- Standard CF8M Body
- Delrin Seats
- ISO 5211 Mounting Flange
- Seal Welded Body
- Blow out proof stem construction
- NPT Threaded End Connections
- Economical
- CRN Certified



CVS Series HPV 30 - 2 Inch

## SPECIFICATIONS – 2 Inch, Full Port

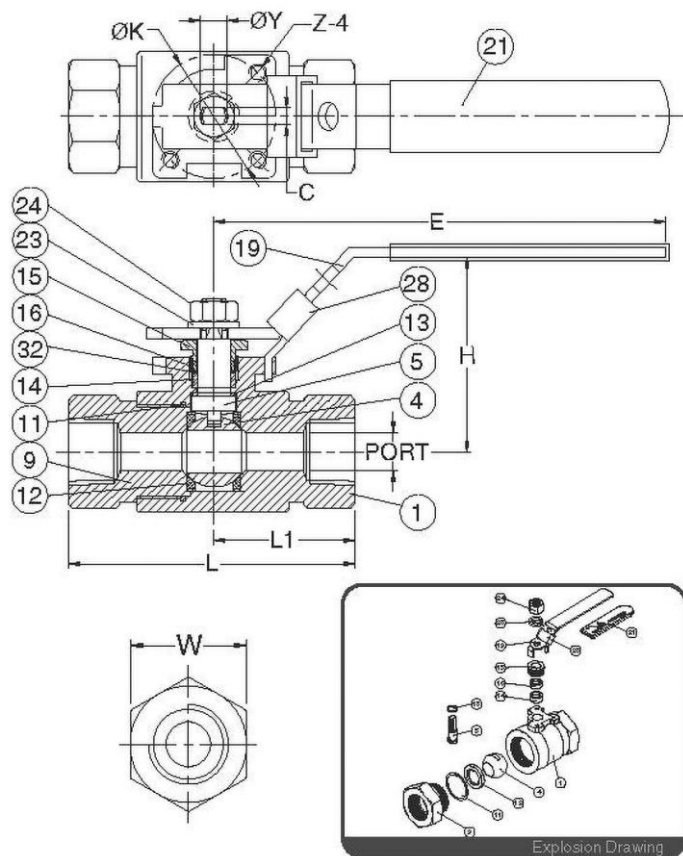

Size	2 Inch	Full Port
End Connection	NPT Threaded Ends	
Working Pressure	3000 psi	
Steam Pressure	150 psig Saturated steam for RTFE	
Temperature Limits Delrin, Standard	-40°C to 80°C	-40°F to 356°F
STANDARDS		
Design	ASME/ANSI B16.34 - latest	
Materials	ASTM	
Pressure Rating	API 598	
CERTIFICATIONS		
CRN		
CE Approval	PED 97/23/EC Module H	
Material Certificate	EN 10204-3.1 MTR	
Quality Assurance	ISO 9001	

### MATERIAL LIST

NO.	PART NAME	MATERIAL ( more options available )
1	BODY	ASTM A351 Gr.CF8M   ASTM A351 Gr.WCB
4	BALL	ASTM A351 Gr.CF8M
5	STEM	ASTM A276 Gr.316
9	END CAP	ASTM A351 Gr.CF8M   ASTM A218 Gr.WCB
11	BODY SEAL	PTFE.
12	SEAT	DELIRIN®+5%CARBON / PEEK
13	THRUST WASHER	DELIRIN®+5%CARBON / PEEK
14	STEM PACKING	PTFE.
15	GLAND NUT	SS304
18	GLAND BEARING	PTFE.
19	HANDLE	SS304
21	HANDLE COVER	PLASTIC
23	HANDLE WASHER	SS304
24	HANDLE NUT	SS304
28	LOCKING DEVICE	SS304
32	PACKING FOLLOWER	PTFE. + 25%G.F.

### DIMENSION

SIZE	PORT	L	L1	E	H	C	ØY	W	ØK	Z
2"	1.46	6.22	3.11	7.17	3.54	0.39	0.63	3.00	F05	1/4"-20UNC

### DIMENSION

SIZE	PORT	L	L1	E	H	C	ØY	W	ØK	Z
2"	37.0	158	79.0	182.0	90.0	10	16.0	76.2	F05	1/4"-20UNC

CVS Controls Ltd. strives for the highest levels of quality and accuracy. The information included in this publication is presented for informational purposes only. CVS Controls Ltd. reserves the right to modify or change, and improve design, process, and specifications without written notice. Under no circumstance is the information contained to be interpreted to be a guarantee/warranty with regard to our products or services, applicability or use.

Selection, use and maintenance are the sole responsibility of the end user and purchaser. CVS Controls assumes no liability for the selection use and maintenance of any product.