



Innometriks and Software House Fully Integrated End-to-End High Assurance Security



Key Features

- Strong identity authentication using smart card, PIN and biometrics
- Cost-effective, powerful PIV/PIV-I/CAC/CIV/TWIC credential validation, enrollment and authentication solution reduces total installation costs with web-based appliance
- Immediate verification of biometric data for secure authentication
- Authentication services embedded in iSTAR Ultra eliminates the need for third party add-on boards
- Efficient design reduces IT management costs with less time required for updating software
- Supports up to 5,000 readers per single server and 40 Satellite Application Servers in an Enterprise environment
- Ensure reliability and business continuity with a comprehensive Cybersecurity Program

Powered by Innometriks High Assurance Security Solution technology, Software House C-CURE 9000 security and event management system PIV/CAC credential validation, registration and authentication suite elevates traditional physical access control systems to meet or exceed the credential authentication requirements set forth by the U.S. Government identity programs.

High Assurance

Innometriks hardware (Cheetah, Cheetah SE, and Rhino High Assurance Smart Card Readers) and software products provide high assurance for mission critical environments including government entities and commercial applications. Strong authentication verifies an individual's identity using technologies including biometrics, smartcards, Public Key Infrastructure (PKI) and digital signatures to provide a level of assurance above and beyond that available through non-smart card ID card mechanisms.

Strong Identity Authentication

Innometriks FICAM enrollment client provides enrollment functions for strong identity authentication that verifies and allows for the capture of the credential and verifies an individual using technologies including biometrics, smart cards, Public Key Infrastructure (PKI) and digital signatures. Strong identity authentication provides greater protection of critical assets and sensitive information.

C•CURE 9000 with embedded iSTAR Ultra PIV Authentication

C•CURE 9000 security solution integrated with the Innometriks High Assurance Solution provides a powerful open architecture that features an end-to-end FICAM-compliant PACS system for PIV/ CAC credential validation, PACS enrollment and fast processing speeds for certificate validation at the reader in under two seconds. With the authentication module built into the iSTAR Ultra the Solution supports ongoing, periodic certificate status updates. All data is stored in the iSTAR Ultra for PKI authentication and continuous PACS access processing, even if the network is down and the controller is offline.

Customizable PIV Card Validation Solution

The Innometriks High Assurance Solution with C•CURE 9000 offers pre-configured layouts or an empty palette for each administrator to customize for ease of use. Using the Innometriks ID Server, with appropriate permissions, you can configure data fields, navigate and perform quick searches and queries—all in real time, all from one interface.

PIV/CAC/TWIC Validation and Registration

With the Innometriks High Assurance Solution you can perform automated imports of PIV credential data from multiple authoritative databases, such as Card Management or Identity Management systems. You can also perform local PIV validation and enrollment via PIV enrollment workstations or PIV enrollment kiosk. An alternate fingerprint feature overcomes poor template issues. This solution meets FIPS-201 processing functionality and TWIC requirements.

Extended Card Format Support

The Innometriks High Assurance Solution within C•CURE 9000 and iSTAR Ultra supports extended card formats of up to 256 bits, providing the utmost in flexibility when configuring custom card formats. iSTAR Ultra supports the full 200-bit FASC-N format for compliance with the U.S. Government's FIPS 201 initiative, as well as the 128-bit GUID format for PIV-I credentials. These extended cardholder formats are stored locally in iSTAR Ultra allowing the controller to make the access decision even when it is offline from C•CURE 9000. Each format supports multiple data fields such as card number, site code, issue code, parity, agency code, system code, plus up to four custom card integer fields. Longer card numbers and formats offer greater protection against card duplication, and are especially valuable to customers who require card numbers that exceed 10 digits.

Supports Software House RM Reader Functionality

Innometriks High Assurance Solution, via the Innometriks Cheetah Smart Card Reader, supports Software House RM Reader functionality for new and existing installations. When using RM Readers, grouping inputs and doors into intrusion zones allows you to easily arm and disarm alarm monitoring points in a defined area which may include an entire facility or a portion of the facility. You can lock and unlock groups of doors while displaying their current mode and status. With simple RM Reader keypad commands, you can remotely activate cameras, doors, and other events as well as trigger a duress call right from a reader keypad connected to an iSTAR Ultra door controller. Keypad commands can be configured to require card presentation and/or a PIN to validate the command.

Exceptionally Reliable Security

C•CURE 9000 provides FIPS 197-approved encrypted communication between both C•CURE 9000, appliance devices, clients, Innometriks PIV readers and between iSTAR Ultra controllers, while Microsoft® Windows Single Sign-On (SSO), field-level audit, and authentication of historical log content feature a digital signature on each event. This allows administrators to detect additions, modifications, or deletions of data which is critical in order to maintain compliance with regulations, such as U.S. Government FIPS-201 processing standards, Sarbanes-Oxley, HIPAA, and 21-CFR Part 11.

Enterprise Scalability

The C•CURE 9000 Enterprise architecture supports the Innometriks High Assurance Security Solution in a MAS (master application server)/ SAS (satellite application server) environment. The solution supports one MAS and up to 40 SAS for enterprise scalability up to 200,000 readers, including the Innometriks Cheetah and Rhino high assurance readers, and 500,000 credentials managed under one system for management, monitoring and reporting. Corporate security personnel and IT managers receive central control over the entire system, while each local facility maintains control of its individual operation. Each SAS may be positioned close to its

relevant field hardware – reducing traffic to the MAS and optimizing performance. Each facility maintains a local SQL database which is synchronized with the MAS for global control and reporting. The MAS distributes these changes globally from each independent SAS, which ensures all servers are equipped and operating with up-to-date information. By connecting a SAS to the LAN with local access control hardware, alarm monitoring and badging workstations, local performance is optimized versus the latency you may experience from the WAN. Local performance is further optimized since the MAS performs all global reporting across all SASs, thus allowing each SAS to allocate its resources solely to important access control functions.

Ensure Reliability and Business Continuity with a Comprehensive Cybersecurity Program

The Innometriks High Assurance Security Solution adheres to the rigorous standards of the Tyco Cyber Protection Product Security Program. The holistic approach to cyber protection is aimed at providing peace of mind to our customers. Our security mindset begins at initial design concept and is supported through deployment, including a rapid incident response to meet the comprehensive and evolving cybersecurity environments.

System Architecture

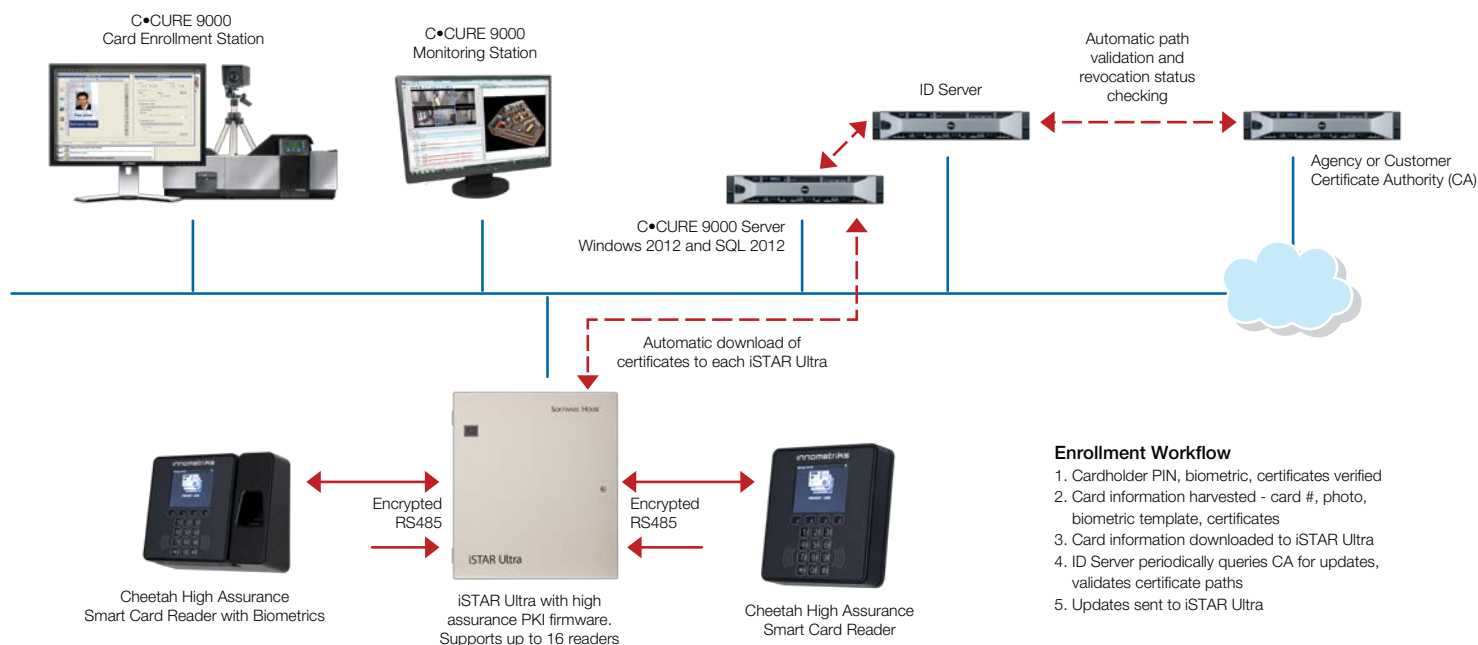

Ordering Information

| Model Numbers | Description |
|-----------------|---|
| Software | |
| INN-IDSVR-SW | Innometriks ID Server software |
| INN-HA-SW-SM | Innometriks High Assurance Software Suite, small |
| INN-HA-SW-MD | Innometriks High Assurance Software Suite, medium |
| INN-HA-SW-LG | Innometriks High Assurance Software Suite, large |
| INN-ENR-LIC | Innometriks Stand-Alone Enrollment Client |
| IDTV-SPR3310 | Identive SPR3310 USB smart card reader |
| SECG-EA4-0089A | Secugen Hamster Pro 20 USB fingerprint enrollment reader |
| INN-USB-BIO | Lumidigm Venus Multi-Spectral USB Bio enrollment device |
| USB-PINPAD | Targus USB PIN pad |
| INN-RDR-LIC | Innometriks High Assurance Reader license |
| INN-RDR-LIC100 | Innometriks High Assurance Reader license, qty 100 |
| INN-RDR-LIC1K | Innometriks High Assurance Reader license, qty 1,000 |
| INN-RDR-LIC5K | Innometriks High Assurance Reader license, qty 5,000 |
| Hardware | |
| INN-RHNO | Rhino High Assurance Smart Card Reader, with keypad and LCD, no read head, indoor, with Lumidigm sensor |
| INN-RHNO-OD | Rhino High Assurance Smart Card Reader, with keypad and LCD, no read head, outdoor, with Lumidigm sensor |
| INN-RHNO-XT | Rhino High Assurance Smart Card Reader, with keypad and LCD, no read head, outdoor, with Lumidigm sensor and outdoor heater kit |
| INN-RHNO-XS | Rhino High Assurance Smart Card Reader, contactless, indoor, with Lumidigm sensor |
| INN-RHNO-XS-OD | Rhino High Assurance Smart Card Reader, contactless, outdoor, with Lumidigm sensor |
| INN-RHNO-XSODW | Rhino High Assurance Smart Card Reader, contactless, outdoor, with Lumidigm sensor, white |
| INN-RHNO-XS-XT | Rhino High Assurance Smart Card Reader, contactless |
| INN-CHTA-RF | Cheetah High Assurance Smart Card Reader, core module, contactless |
| INN-CHTA-RF-OD | Cheetah High Assurance Smart Card Reader, core, module, contactless, outdoor |
| INN-CHTA-CT | Cheetah High Assurance Smart Card Reader, core with contact module |
| INN-CHTA-CT-OD | Cheetah High Assurance Smart Card Reader, core with contact module, outdoor |
| INN-CHTA-BIO | Cheetah High Assurance Smart Card Reader, core with biometric module |
| INN-CHTA-BIO-CT | Cheetah High Assurance Smart Card Reader, core with contact and biometric module (full modal) |
| INN-SECHTA-RFO | Cheetah SE High Assurance Smart Card Reader, with keypad and LCD, contactless only, indoor/outdoor |
| INN-SECHTA-CTO | Cheetah SE High Assurance Smart Card Reader, with keypad and LCD, contact/contactless, indoor/outdoor |

About Johnson Controls

Johnson Controls is a global diversified technology and multi-industrial leader serving a wide range of customers in more than 150 countries. Our 120,000 employees create intelligent buildings, efficient energy solutions, integrated infrastructure and next generation transportation systems that work seamlessly together to deliver on the promise of smart cities and communities. Our commitment to sustainability dates back to our roots in 1885, with the invention of the first electric room thermostat.